



Accommodation

- Replace and improve existing older cabins to provide affordable family accommodation.
- Replace safari tents with high quality 3 bedroom cabins
- Upgrade camp sites to improve size and provide amenities
- Continue to provide for a mix in on-site accommodation forms.
- Upgrade utility services to support additional accommodation.

Safety

- Ensure the application of OH&S requirements throughout the Park.
- Ensure appropriate safety measures for pedestrian crossing of Shoal Bay Road.
- Implement CCTV surveillance at strategic locations.
- Improve entry/exit of vehicles
- Replace boundary fencing and provide pedestrian gates

Recreational Facilities

- Upgrade and expand existing recreational facilities to support the total accommodation provision within the Park.
- Consider relocating children's playground to rear of ablution building to allow for water playground/wading pool complex in its place (red asterisk).

Land Status

- Close the affected area of the Shoal Bay Road Reserve under the provisions of the Roads Act 1993 and classify it as operational land under the provisions of the Local Government Act.
- Determine the highest and best use of areas within the caravan park having regard to current land use controls and ownership.
- Discuss with LPMA potential alternative uses of adjacent Reserved Crown land.

Boundaries

- Ensure operational boundaries are correctly located and defined.
- Provide and maintain fencing and buffer plantings where necessary and address climatic considerations such as prevailing winds.
- Provide pedestrian and vehicular access points to match desire lines and linkages.
- Apply appropriate bushfire management practices.

- SHOAL BAY HOLIDAY PARK
- HOLIDAY VAN SITES
- ENTRY PRECINCT
- CABINS
- RECREATION + SERVICES
- CAMP SITES
- TOURIST SITES
- SEPP 14 WETLANDS

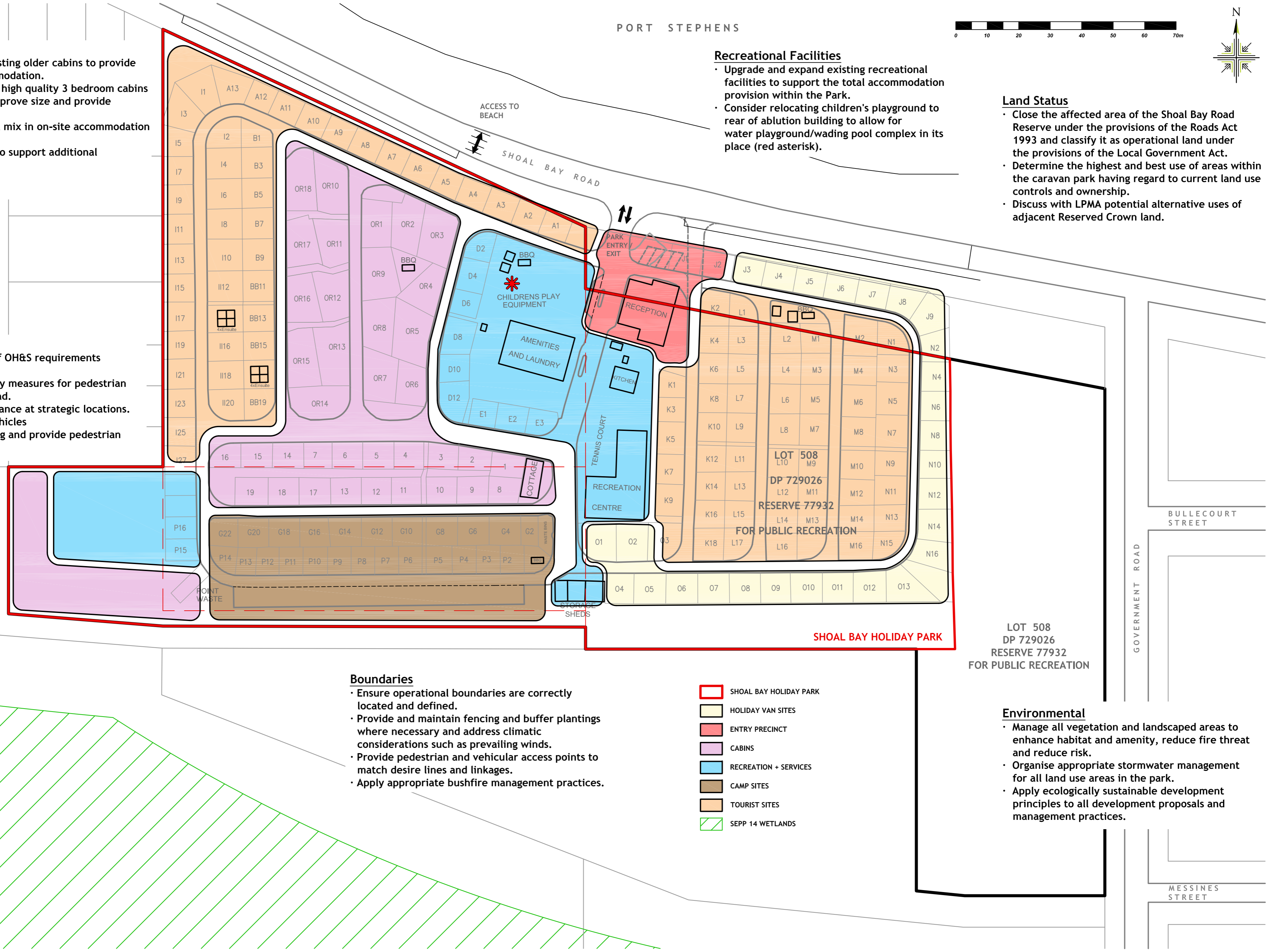

LOT 508
DP 729026
RESERVE 77932
FOR PUBLIC RECREATION

Environmental

- Manage all vegetation and landscaped areas to enhance habitat and amenity, reduce fire threat and reduce risk.
- Organise appropriate stormwater management for all land use areas in the park.
- Apply ecologically sustainable development principles to all development proposals and management practices.