

© 2007 All rights reserved. No part of this plan may be reproduced, stored in a retrieval system or transmitted in any form or by any means electronic, mechanical, photocopying, recording or otherwise without the written permission of Integrated Site Design Pty Ltd  
 P O Box 6396, Alexandria, NSW 2015  
 701 / 247 Coward Street, Mascot, NSW 2020  
 t : (02) 8338 1722 f : (02) 8338 1733 e : isd@isd.com.au w : www.isd.com.au

**Accommodation**

- Reduce the proportion of holiday vans in favour of tourist sites. Where possible, holiday vans to be relocated in accordance with management requirements.
- Revise the layout of camp sites & consolidate in northern area of park.
- Rationalise and upgrade drive-on tourist sites.
- Provide additional quality cabin accommodation.
- Provide for a mix in on-site accommodation forms.
- Upgrade utility services to support additional accommodation.
- Vary park road layout to allow for the changes in the accommodation mix.

**Safety**

- Ensure the application of OH&S requirements throughout the Park.
- Ensure appropriate safety measures for pedestrian crossing of Marine Drive.
- Implement CCTV surveillance at strategic locations.

**Boundaries**

- Ensure operational boundaries include the necessary lands and correctly define the park and the dwelling sites.
- Provide and maintain fencing and buffer plantings where necessary.
- Provide pedestrian and vehicular access points to match desire lines and required linkages, including potential service access from Farm Road.

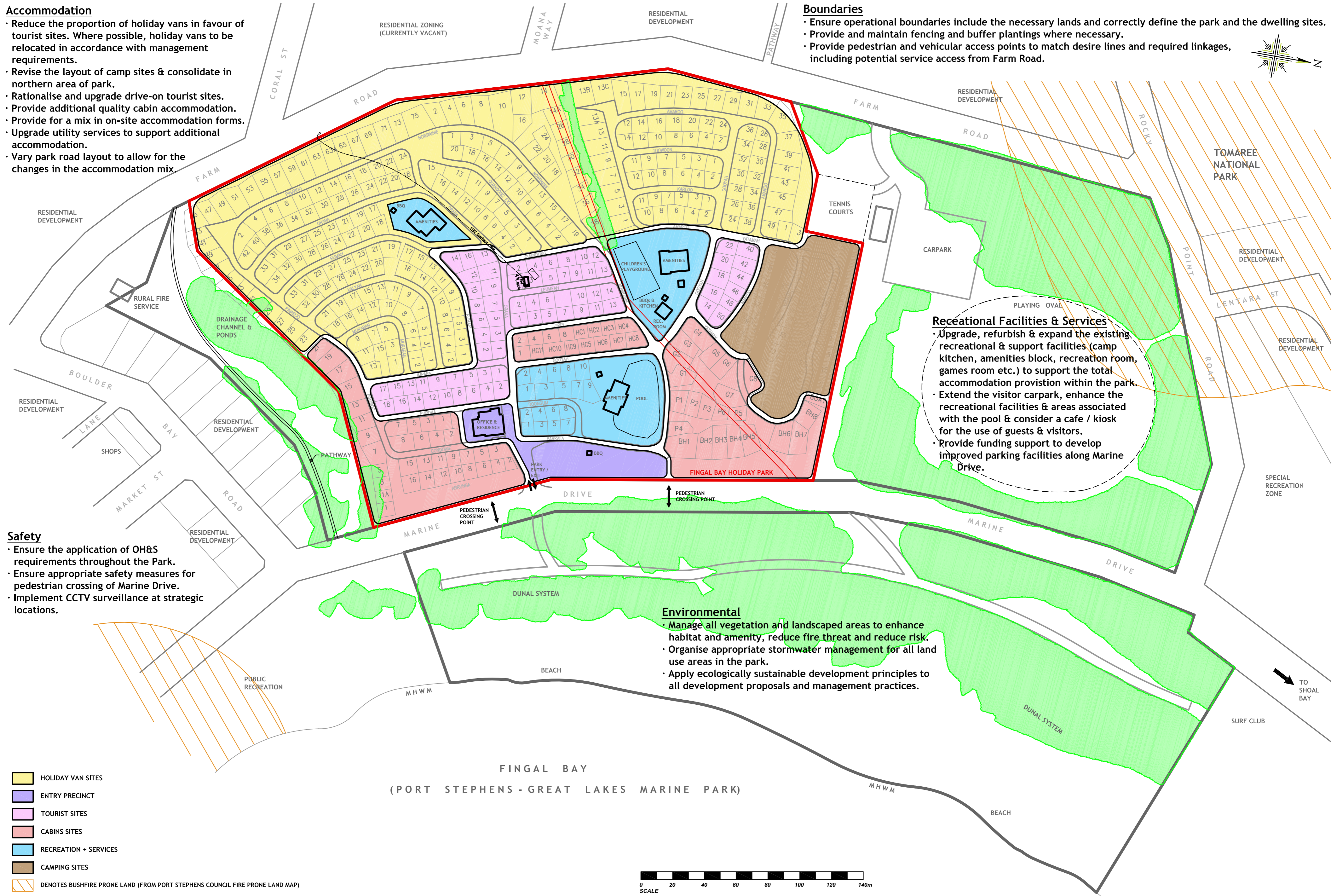

**Recreational Facilities & Services**

- Upgrade, refurbish & expand the existing recreational & support facilities (camp kitchen, amenities block, recreation room, games room etc.) to support the total accommodation provision within the park.
- Extend the visitor carpark, enhance the recreational facilities & areas associated with the pool & consider a cafe / kiosk for the use of guests & visitors.
- Provide funding support to develop improved parking facilities along Marine Drive.

**Environmental**

- Manage all vegetation and landscaped areas to enhance habitat and amenity, reduce fire threat and reduce risk.
- Organise appropriate stormwater management for all land use areas in the park.
- Apply ecologically sustainable development principles to all development proposals and management practices.

- HOLIDAY VAN SITES
- ENTRY PRECINCT
- TOURIST SITES
- CABINS SITES
- RECREATION + SERVICES
- CAMPING SITES
- DENOTES BUSHFIRE PRONE LAND (FROM PORT STEPHENS COUNCIL FIRE PRONE LAND MAP)